

DOCUMENT 00 91 01

ADDENDUM NO.1

ISSUED: October 08, 2018

**PROJECT #Z-060-817
DW INFRASTRUCTURE – EXTERIOR PAINTING (YB)
BID #: B-05-18-19**

1. GENERAL

This document includes requirements that clarify or supersede portions of the bid and/or contract requirements for the project. This Addendum is a Contract Document.

- **Please acknowledge this Addendum on Bid Form and Proposal Document 00 41 13.**

2. SUMMARY

The following changes, additions and deletions shall be made to the following document(s); all other conditions shall remain the same.

1) DRAWINGS REVISIONS

Sheet A1.0 – Site Plan

-Added missing exterior fencing & removed chain-link fencing at tennis courts

Sheet A2.0 – Schedule & General Notes

-Added note to schedule to remove moss from roof

- 2) **QUESTION:** Please provide clarification as to how the principal will coordinate children while we are painting.

RESPONSE: The awarded contractor shall work with district to confirm the paint and roof cleaning scheduling for each building. The awarded contractor shall provide signage and safety measures to keep people away from their work as the campus will be occupied during this time.

- 3) **QUESTION:** Each of the buildings 200, 300, 600, 700, 900, and 1100 have roof parapets. Are these included in the painting scope? If so, what is the paint schedule for them?

RESPONSE: The parapets for these buildings are not in the project scope.

- 4) **QUESTION:** The provided drawing shows some fencing area in green while the exterior fencing area is in blue. But green is the color of Main Buildings, please clarify.
RESPONSE: Please reference revised sheet A1.0 from addendum 1 (drawing dated 10/08/2018).
- 5) **QUESTION:** Not all perimeter fencing is correctly shown in the map. Please provide an up-to-date map.
RESPONSE: Please reference revised sheet A1.0 from addendum 1 (drawing dated 10/08/2018).
- 6) **QUESTION:** The blue fencing shown between the tennis courts and the stadium is unpainted chain-link fence, and not the typical green perimeter fencing. Please clarify if this chain-link fence needs to be painted, and if so, what is the paint schedule?
RESPONSE: Please reference revised sheet A1.0 from addendum 1 (drawing dated 10/08/2018).
- 7) **QUESTION:** There's a chain link fence between buildings 900 and 1100. Is this in the scope? The map does not show this fence.
RESPONSE: Please reference revised sheet A1.0 from addendum 1 (drawing dated 10/08/2018).
- 8) **QUESTION:** Some of the green fencing between 1100 and 100 is severely rusted and broken (perhaps at other locations too). Please clarify if any rustproofing is in the scope of work.
RESPONSE: Please reference project specifications, prepare surfaces as required to apply paint.
- 9) **QUESTION:** The parapets of the gymnasium were added to the scope during the first job walk. Please confirm and also the paint schedule.
RESPONSE: Parapets are an extension of the main body and will follow the same color scheme: Gauntlet Gray (SW7019) with eggshell sheen.
- 10) **QUESTION:** The chain link fence between the gymnasium and the covered parking lot was added to the scope during the first job walk. Please confirm and also the paint schedule.
RESPONSE: Please reference revised sheet A1.0 from addendum 1 (drawing dated 10/08/2018).
- 11) **QUESTION:** The bollards between the gymnasium and the driveway were indicated to be added to the scope. Please clarify.
RESPONSE: Bollards are not part of the scope of work.

12) QUESTION: To the left of 900 (in the map), there is a green covered shed. Is this in scope? Also, the green roll-up doors on the west side of 900.

RESPONSE: Please reference revised sheet A7.0 (drawing dated 09/021/2018) for utility shack. Roll-up doors are not part of scope.

13) QUESTION: Please clarify if the ESUHSD will enable more than buildings among 200-900 be painted together or is it envisaged that only one of these buildings at a given time will be closed for painting. Please provide a week-wise closing schedule. Similarly for the portables.

RESPONSE: Please reference Question 2 from addendum 1 (issued 10/08/2018).

14) QUESTION: Can the District provide allowance as a dollar amount or SF/ LF for the above work incl. dry rot repairs?

RESPONSE: There is an allowance for dry rot repair, the area is 10 lf and occurs at building 600 above room 655.

END OF DOCUMENT

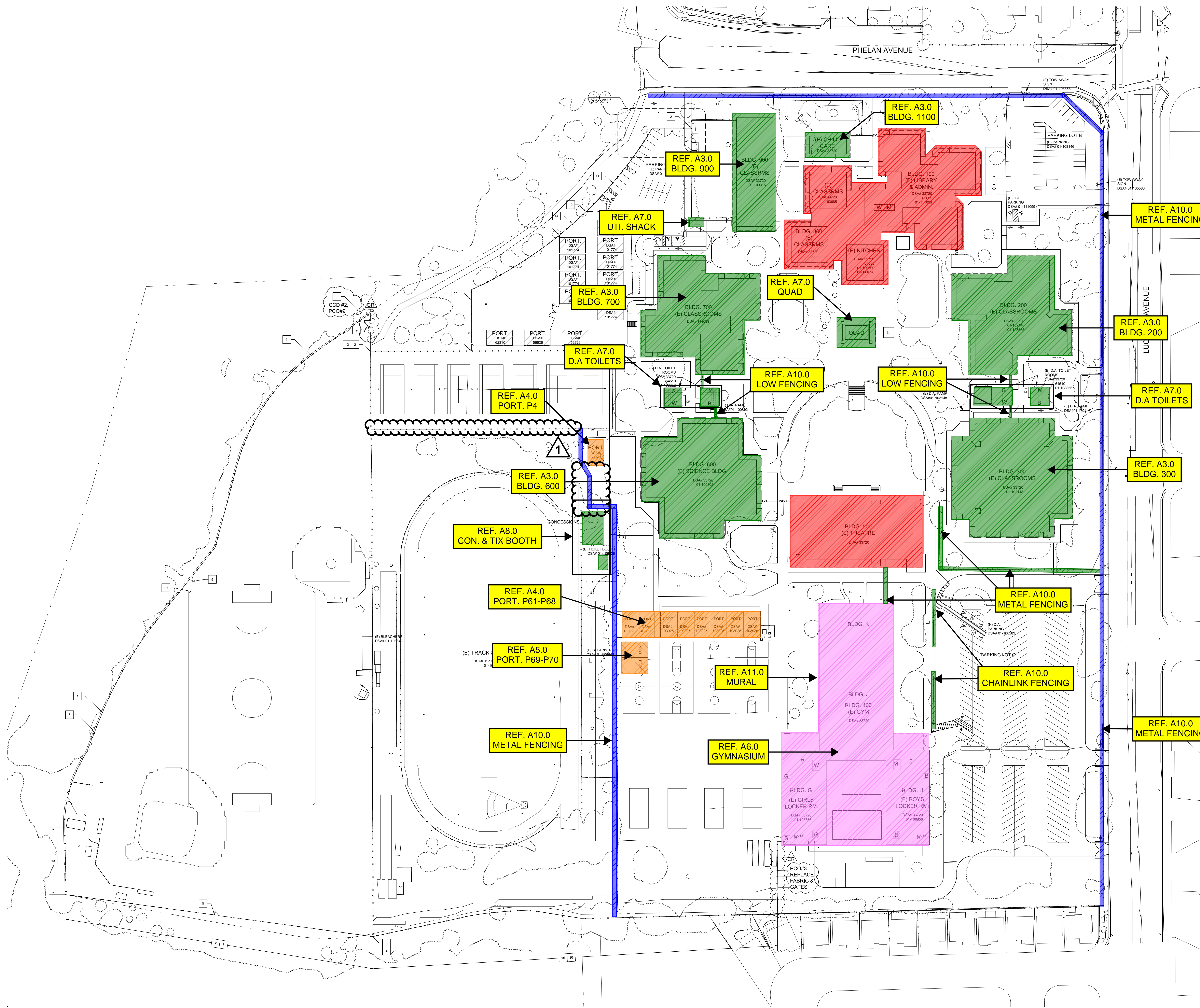

- PAINT MAIN BUILDINGS
- PAINT EXTERIOR FENCING
- PAINT PORTABLES
- PAINT GYMNASIUM
- NOT IN PROJECT SCOPE

DW INFRASTRUCTURE - EXTERIOR PAINTING (YB)
YERBA BUENA HIGH SCHOOL
 1855 LUCRETIA AVE., SAN JOSE, CA 95122

PROJECT#
Z-060-817

BID#
B-05-18-19

DRAWING DATE
10/08/2018

A1.0
SITE PLAN

1 YERBA BUENA SITE PLAN



GENERAL NOTES

1. CONTRACTOR TO VERIFY ALL QUANTITIES OF BUILDINGS AND FIXTURES.
2. FOR ALL BUILDINGS IN SCOPE OF WORK, REMOVE GRAFFITI FROM ROOF TILES, BRICK WALLS, & CONCRETE COLUMNS.
3. FOR ALL BUILDINGS IN SCOPE OF WORK, POWER WASH ROOF TILES, BRICK WALLS, & CONCRETE COLUMNS AFTER COMPLETING PAINTING.
4. FOR ALL BUILDINGS IN SCOPE OF WORK, PROTECT AND CLEAN LIGHTING FIXTURES, VENTS, SPEAKERS, AND ALL OTHER BUILDING MOUNTED FIXTURES NOT CALLED OUT TO BE PAINTED.
5. FOR ALL HOLLOW METAL FRAMES WITHIN SCOPE OF WORK, PAINT BOTH EXTERIOR AND INTERIOR SIDES.
6. FOR FENCING WITH FOLIAGE, REMOVE FOLIAGE AND PREPARE PER MANUFACTURER INSTRUCTIONS PRIOR TO PAINT.
7. COLOR ON PAINT SCHEDULE MAY BE CUSTOM TINTED FOR DISTRICT, CONTRACTOR TO VERIFY COLOR TINTS AS PART OF SUBMITTAL.
8. AREAS OF WORK TO BE CAUTIONED AND SAFE-OFF TO PREVENT PUBLIC ENTRY.
9. PROTECT ALL AREAS NOT BEING PAINTED OR ADJACENT AREAS WHERE AREAS BEING STRIPPED.
10. CONTRACTOR TO COORDINATE WORK WITH DISTRICT CM FOR ALL AREAS DURING SCHOOL PERIOD.

BUILDING & FIXTURE SCHEDULE

DESCRIPTION	QUANTITY	REF. SHEET	BID ITEM	NOTES
BUILDING 200	1	A3.0	1	POWER WASH ROOF TILES, BRICK WALLS & CONCRETE COLUMNS; CLEAN LIGHT FIXTURES; CLEAR MOSS AT ROOF TILES
BUILDING 300	1	A3.0	1	POWER WASH ROOF TILES, BRICK WALLS & CONCRETE COLUMNS; CLEAN LIGHT FIXTURES; CLEAR MOSS AT ROOF TILES
BUILDING 600	1	A3.0	1	POWER WASH ROOF TILES, BRICK WALLS & CONCRETE COLUMNS; CLEAN LIGHT FIXTURES; CLEAR MOSS AT ROOF TILES; REPAIR WOOD FACIA AT RM. 655
BUILDING 700	1	A3.0	1	POWER WASH ROOF TILES, BRICK WALLS & CONCRETE COLUMNS; CLEAN LIGHT FIXTURES; CLEAR MOSS AT ROOF TILES
BUILDING 900	1	A3.0	1	POWER WASH ROOF TILES, BRICK WALLS & CONCRETE COLUMNS; CLEAN LIGHT FIXTURES; CLEAR MOSS AT ROOF TILES
BUILDING 1100	1	A3.0	1	POWER WASH ROOF TILES, BRICK WALLS & CONCRETE COLUMNS; CLEAN LIGHT FIXTURES; CLEAR MOSS AT ROOF TILES
PORTABLES TYPE 1	9	A4.0	2	REPAIR GUTTER AT P62 & P63; APPLY ANTI-SKID TO RAMP
PORTABLES TYPE 2	2	A5.0	2	APPLY ANTI-SKID TO RAMP
GYMNASIUM	1	A6.0	3	
COURTYARD-QUAD	1	A7.0	1	POWER WASH BRICK COLUMNS; CLEAN LIGHT FIXTURES
UTILITY SHACK (BLDG. 900)	1	A7.0	1	POWER WASH BRICK WALL
D.A. TOILET ROOMS	4	A7.0	1	POWER BRICK WALLS & CONCRETE COLUMNS; CLEAN LIGHT FIXTURES
CONCESSIONS	1	A8.0	1	CLEAN LIGHT FIXTURES, BOXES, AND ROLL-UP DOOR
TICKET BOOTH	1	A8.0	1	CLEAN LIGHT FIXTURES, BOXES, AND ROLL-UP DOOR
BACKFLOW PREVENTER	5	A9.0	9	
CONTAINERS	15	A9.0	10	
WOOD TABLE/BENCHES	4	A9.0	13	
SWITCHGEAR (FLOOR MOUNTED)	1	A9.0	11	
DUST COLLECTOR (BLDG. 900)	1	A9.0	12	
CONCRETE TRASH CANS	42	A9.0	8	
CONCRETE PLANTERS	17	A9.0	14	
LIGHT POLES	35	A10.0	7	PAINT POSTS ONLY; CLEAN HEAD
BASKETBALL POLES	7	A10.0	4	STRIP PAINT & CLEAN
LIGHT POLES (CONCRETE BASE)	3	A10.0	5	STRIP PAINT & CLEAN; PROTECT LIGHT POST BASE & POLE WHEN STRIPPING
CONDUITS & BOXES (BLDG. MOUNTED)	*	A10.0	*	
METAL FENCING	*	A10.0	1	IF FENCING HAS FOLIAGE, REMOVE PRIOR TO PAINTING
PERIMETER METAL FENCING	*	A10.0	6	IF FENCING HAS FOLIAGE, REMOVE PRIOR TO PAINTING
METAL RAILS	*	A10.0	*	SAND RAILS PRIOR TO PAINTING; ONLY PAINT RAILS THAT HAVE BEEN PREVIOUSLY PAINTED, LEAVE EXPOSED RAILS EXPOSED
LOW FENCING & CHAINLINK FENCING	*	A10.0	1	IF FENCING HAS FOLIAGE, REMOVE PRIOR TO PAINTING
GYMNASIUM MURAL	1	A11.0	15	CONCEPT ONLY - MURAL SUBJECT TO CHANGE

PAINT COLOR SCHEDULE

COLOR 1
 MANUFACTURER: DUNN EDWARDS
 COLOR: DESERT SUEDE (DE6206)
 PRODUCT: EVSH30
 SHEEN: EGGSHELL

COLOR 2
 MANUFACTURER: DUNN EDWARDS
 COLOR: CENTER RIDGE (DE6230)
 PRODUCT: EVSH30
 SHEEN: EGGSHELL

COLOR 3
 MANUFACTURER: DUNN EDWARDS
 COLOR: GAUNTLET GRAY (SW7019)
 PRODUCT: EVSH30
 SHEEN: EGGSHELL

COLOR 4
 MANUFACTURER: DUNN EDWARDS
 COLOR: GUNMETAL BRONZE (DEB001)
 PRODUCT: EVSH30
 SHEEN: EGGSHELL

COLOR 5
 MANUFACTURER: DUNN EDWARDS
 COLOR: HOPE CHEST (DEA160)
 PRODUCT: EVSH30
 SHEEN: EGGSHELL

COLOR 6
 MANUFACTURER: DUNN EDWARDS
 COLOR: CAVERNOUS (DE6364)
 PRODUCT: EVSH30
 SHEEN: EGGSHELL

COLOR 7
 MANUFACTURER: DUNN EDWARDS
 COLOR: ESSEX GREEN
 PRODUCT: EVSH50
 SHEEN: SEMI-GLOSS

COLOR 8
 MANUFACTURER: DUNN EDWARDS
 COLOR: SMOKE (RO SMOKE)
 PRODUCT: RUST, PORCH & FLOOR
 SHEEN: ANTI-SKID

DW INFRASTRUCTURE - EXTERIOR PAINTING (YB)
YERBA BUENA HIGH SCHOOL
 1855 LUCRETIA AVE., SAN JOSE, CA 95122

PROJECT#
 Z-060-817

BID#
 B-05-18-19

DRAWING DATE
 10/08/2018

A2.0
 SCHEDULE &
 GENERAL NOTES